

Handwritten: 1.6

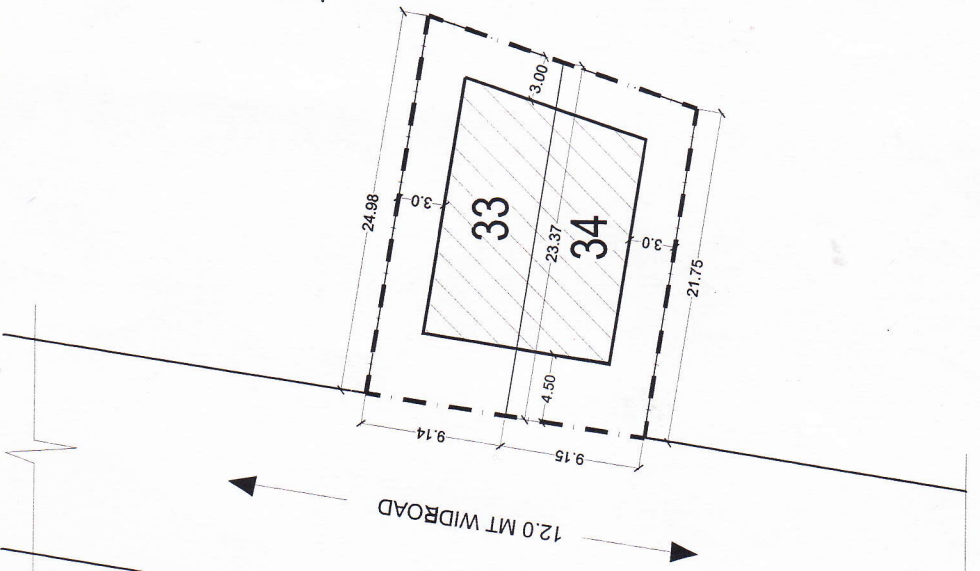

STATEMENT OF AREAS	
PLOT NO. 33 ,	
PLOT SIZE = 9.14 M X (23.37 M+24.98 M)/2	
PLOT AREA = 220.95 sq . mt.	
PLOT NO. 34 ,	
PLOT SIZE = 9.14 M X (23.37 M+21.75 M)/2	
PLOT AREA = 206.42 sq . mt.	
PLOT DIMENSIONS OF PLOT NO. 33 & 34	
PLOT SIZE = 18.28 M X (24.98 M + 21.75 M) /2	
PLOT AREA = 427.11 sq . mt.	
MARGINAL OPEN SPACE AFTER MERGER OF PLOT NO. 33 & 34	
FRONT :- 4.5 M	
REAR :- 3.0 M	
L.H.S. :- 3.0 M	
R.H.S. :- 3.0 M	

PROJECT TITLE

PROPOSED PLAN OF MERGER OF PLOT NO. 33,& 34
 OF FLORA RESIDENCY AT GRAM NAYA PURA
 ALGHA NEAR-NEVRI MANDIR, DIST.BHOPAL.

OWNER

PLOT NO. 33
 SHRI SUNIL KUMAR JAIN
 S/O, LATE SHRI GULAB CHAND JAIN
 ADD:- C-139, KOHE- FIJAH, BHOPAL.

PLOT NO. 34
 SHRI SANJAY KUMAR JAIN
 S/O, LATE SHRI GULAB CHAND JAIN
 ADD:- C-139, KOHE- FIJAH, BHOPAL.

ARCHITECT

DR. RITESH HARWANI
 RITESH HARWANI
 Architect & Interior Designer
 M.C.B. LIC. NO. - A-151 COA Reg.No. CA/96/19906
 T.R.C.P. LIC. NO. - A/30 E-3/22 B, Nupur Kuni, Arera Colony
 COA REG. NO. - CA/96/19906 Bhopal-76 (M.P.) Ph. 2669405,3134949

DESIGN UNIT
 DEALT - SAROJ
 DATE - 18-02-2013
 SCALE - 1:500

Design Unit
 DR. RITESH HARWANI
 E-3/22-B, NUPUR, KUNI,
 ARERA COLONY, BHOPAL
 PH. NO. - 683134918

Handwritten signature

Handwritten: 1.6